

Meissa CNC

by Gildas Gatel

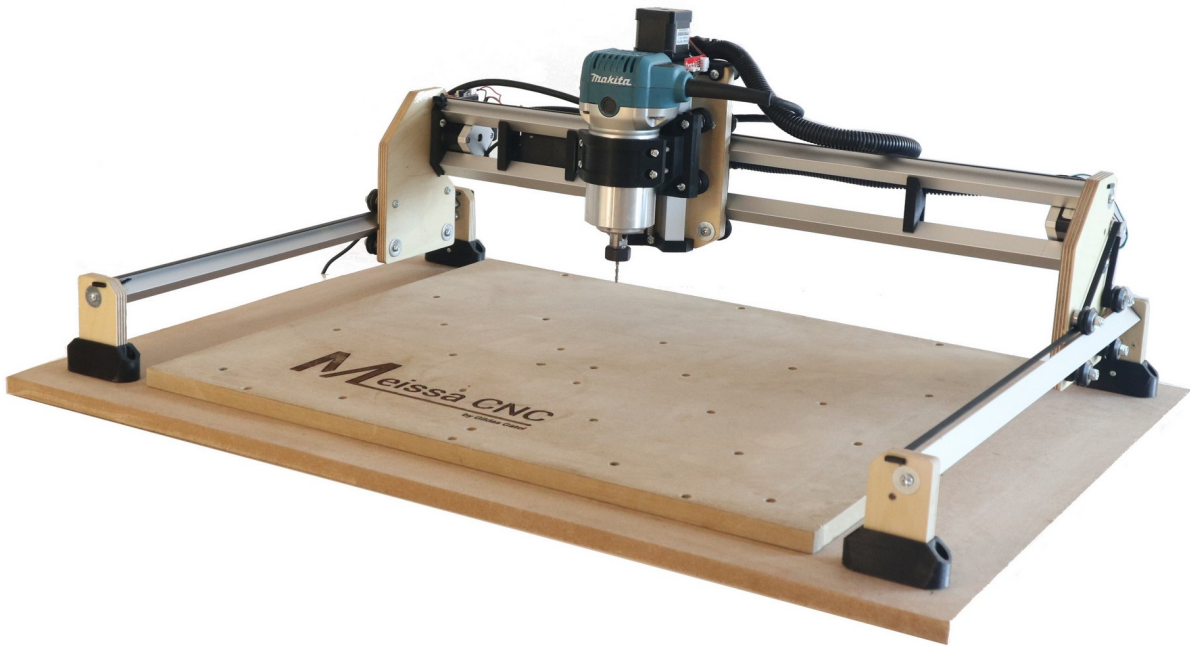

Meissa 4 Kit

ASSEMBLY MANUAL FOR MEISSA 4

REV 1121

Meissa 4 CNC machine

We are delighted that you purchased the Meissa 4 Kit from Meissa CNC and we know you will enjoy using it. This manual gives you step-by-step instructions to ensure success in assembling your Meissa 4 and provides useful information to get started quickly. Before starting the assembly, please take all the time you need to read the manual. It is best to be familiar with the different steps before starting the assembly.

Welcome to the world of CNC. Follow the guide !

Characteristics

Space required for the machine:

X Axis 31" 1/2 - 800mm Y Axis 21" 1/2 - 546mm Z Axis 12" 1/2 - 317mm

Working area:

X Axis 20" 1/2 - 520mm Y Axis 14" 1/2 - 365mm Z Axis 3" - 75mm

Safety Precautions and Warnings

Meissa series CNC machines have a power supply of 110-220V and use bits up to a speed of 30,000 RPM with sharp and dangerous edges. The operator must understand the potential dangers and he is responsible for taking the appropriate safety measures and necessary precautions before using the CNC.

- Only use extension cords rated for 20 amps plugged into a dedicated outlet.
- Inspect the machine before each use to prevent maintenance problems : loose fasteners, belts, etc ...
- Do not operate the CNC machine with dull or damaged router bits.
- Always unplug the machine after each use and when cleaning the router or changing the router bit.
- Remove rings, bracelets, watches, necklaces before using the CNC machine.
- Wear well-fitting clothing and / or roll up long sleeves to avoid snags.
- Use appropriate personal protective equipment (PPE) when operating the machine including safety glasses and hearing protection.
- Keep hands, hair and clothing away from moving parts of the machine.
- Do not use the machine under the influence of alcohol or drugs.
- Make sure the workpiece is tightened in place before you start machining.
- Never leave the machine running unattended.
- Children must be supervised by adults when using the CNC machine.
- Do not use the machine in the presence of flammable materials.
- Keep floors clean, dry and free of debris to eliminate the risk of slipping and / or tripping.
- Have a suitable fire extinguisher readily available when the machine is in operation.



This kit contains small components that present a risk of choking to children and domestic animals. Keep the kit parts out of the reach from small children and domestic animals.

Made in Quebec, Canada
<https://meissacnc.com>
contact@meissacnc.com

List of parts

Components

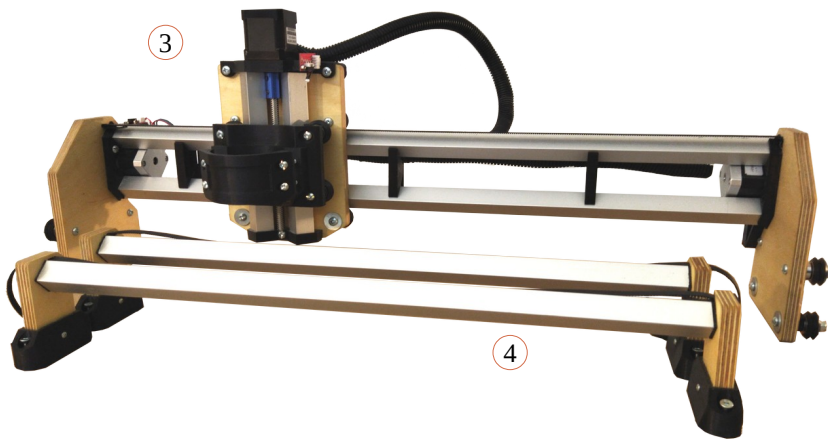

Accessories



No.	Name	Quantity
①	12v 5A Power supply	1
②	USB cable	1
③	Gantry	1
④	Rail	2
⑤	Tensioner	2
⑥	Tensioner screw	2
⑦	Nut	2
⑧	Bed screw	8

Step 1

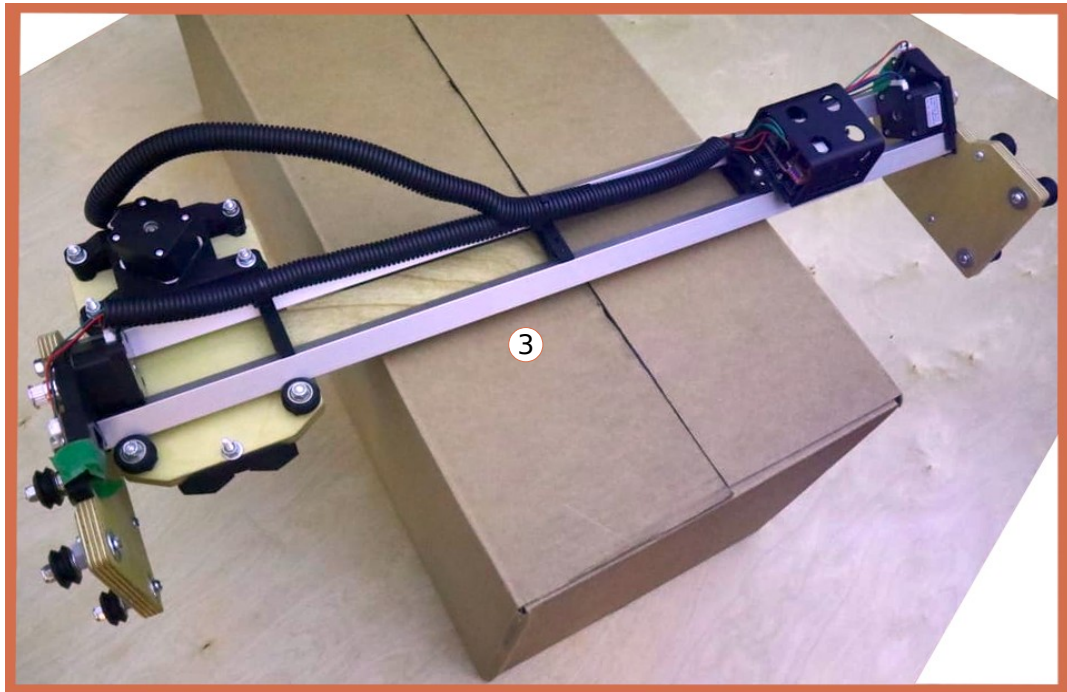

Empty the box. To facilitate assembly, you can place the gantry on the closed box.

Step 2

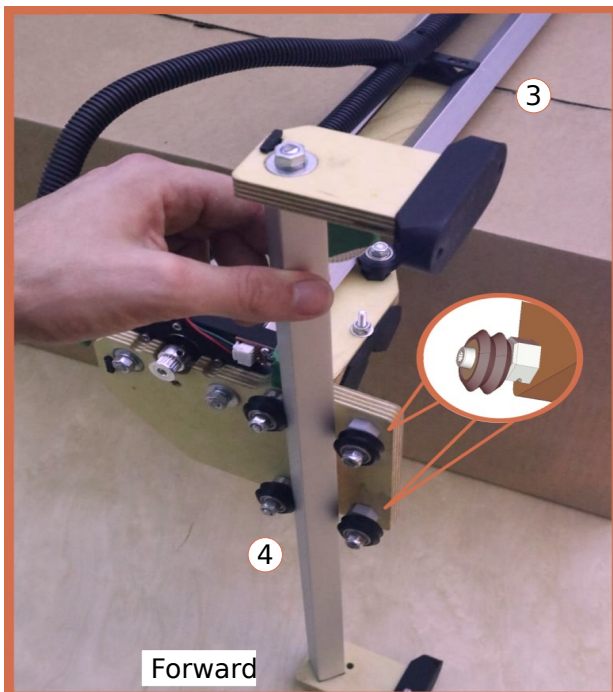

Install the rails on the gantry with the eccentric screw marker facing down.
Pay attention to the direction of the rail.

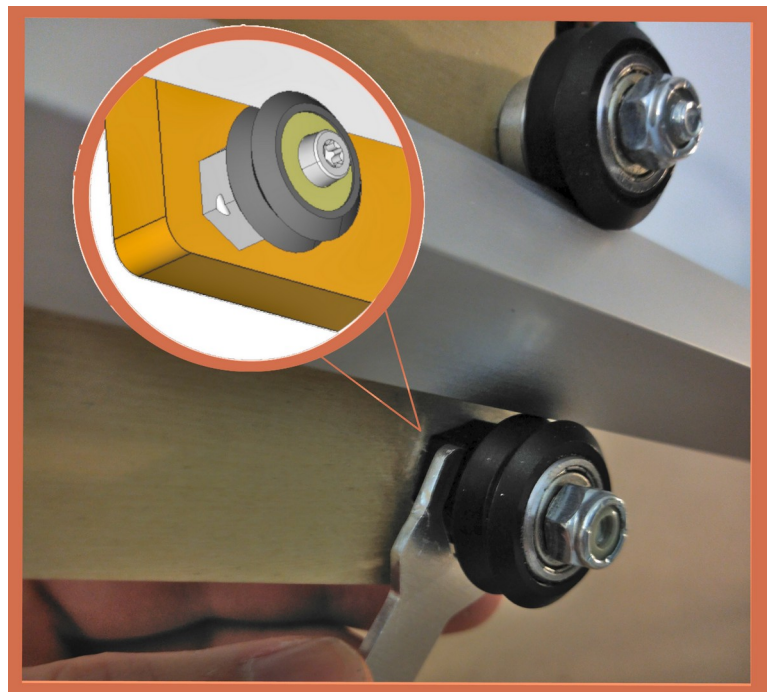

Turn the two eccentric screws to tighten the pulleys to the rail.
Be careful not to over-tighten, the rail must be able to slide freely.

Step 3



Lock the position by tightening the center screw.

Step 4

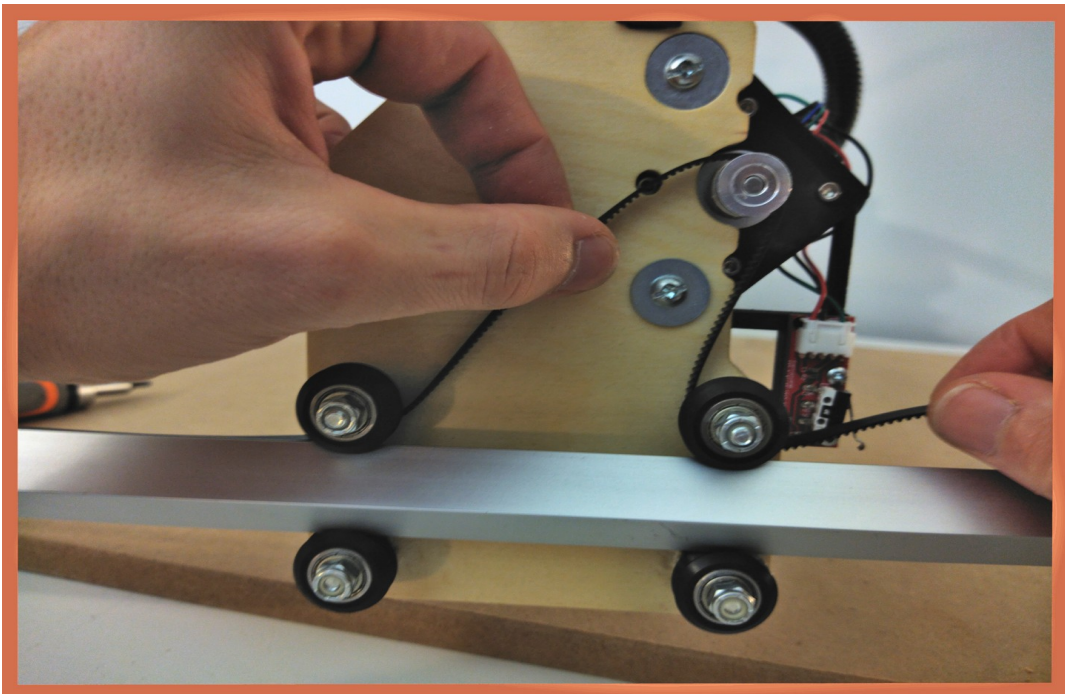

Place the belt around the stepper motor pulley.

Step 5

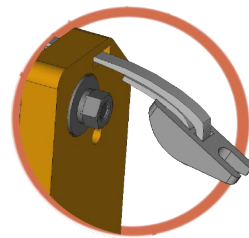
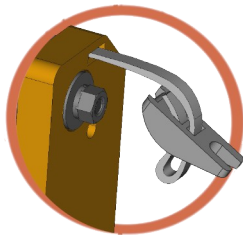
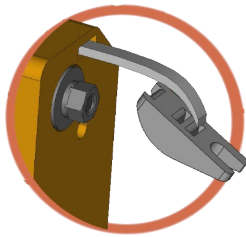
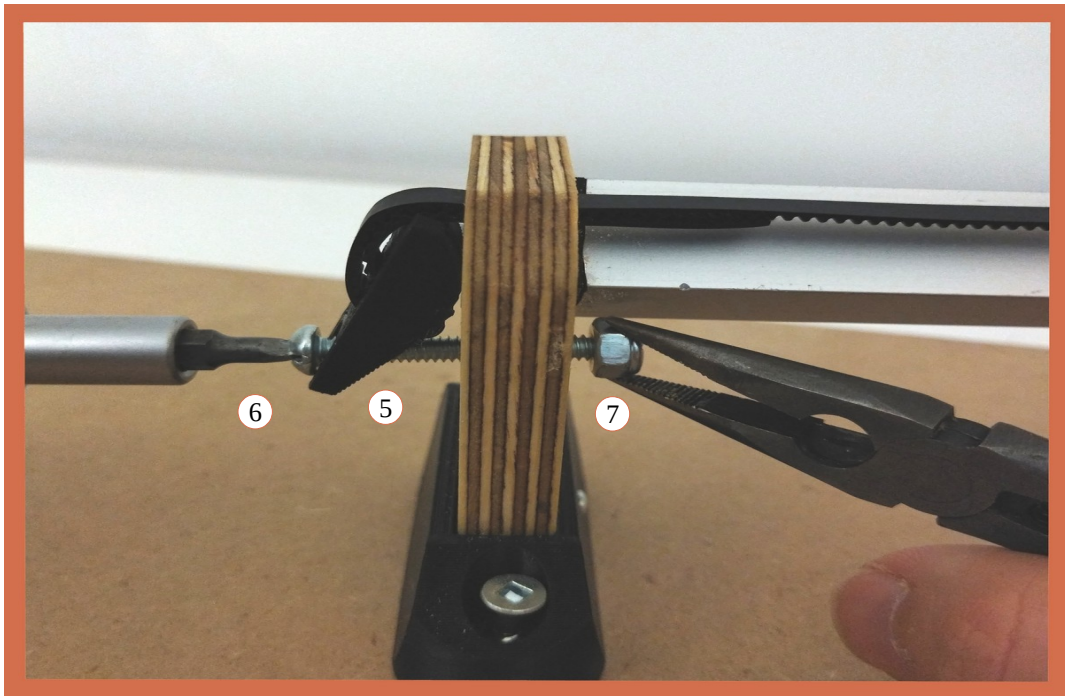

Install the tensioner on the back of the rail and adjust the tension.
Be careful not to tighten the belt too much.

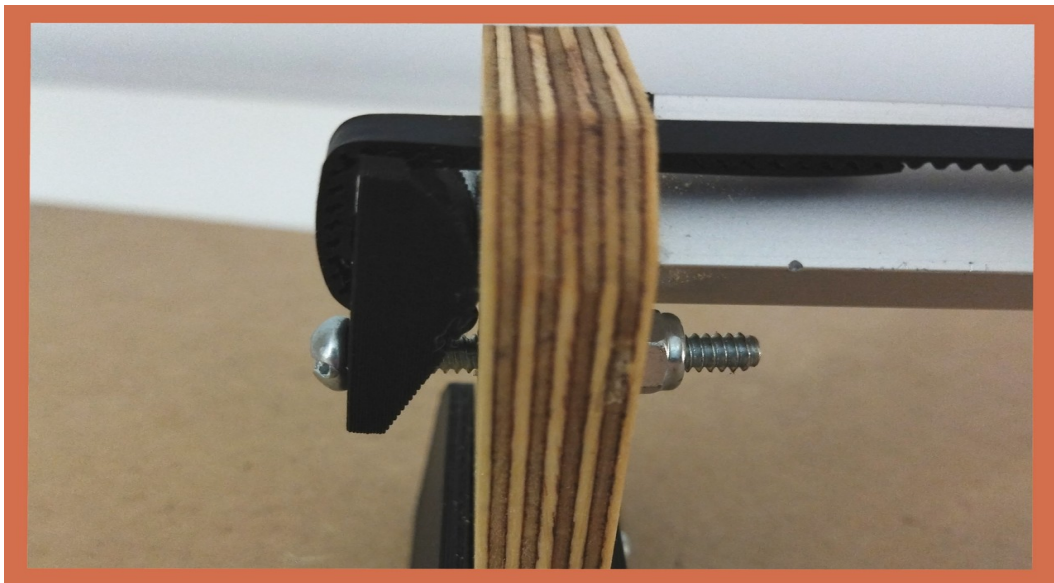

Final result

Step 6



Carry out steps 1 to 5 for both rails.

Step 7

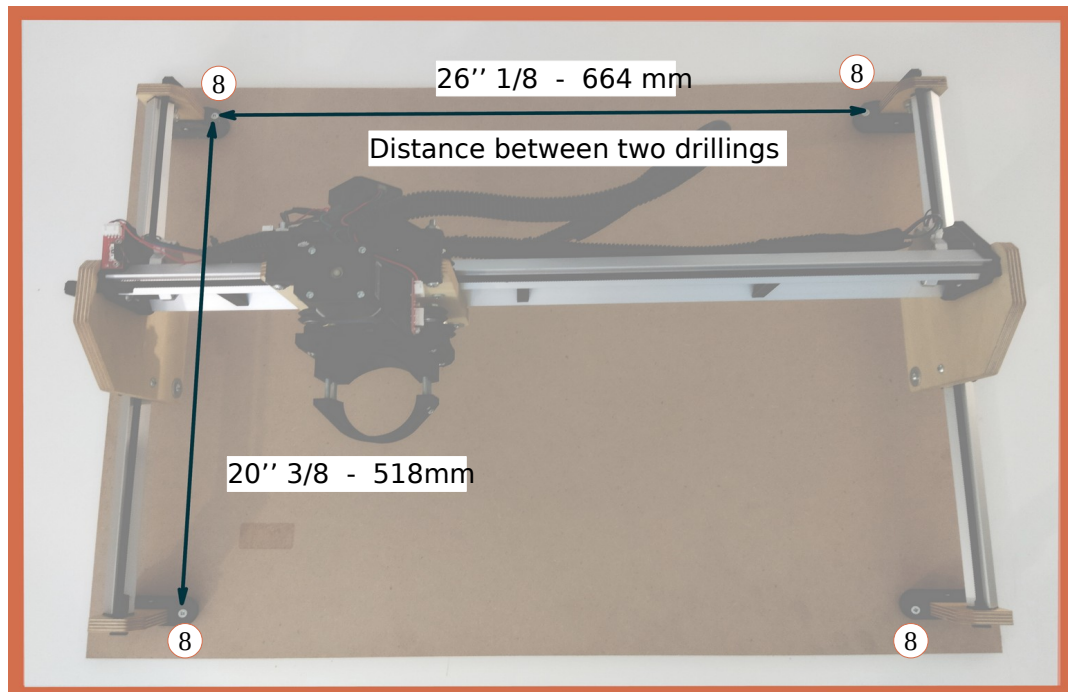

Fix the CNC machine on the support (or spoilboard) of your choice.

Step 8

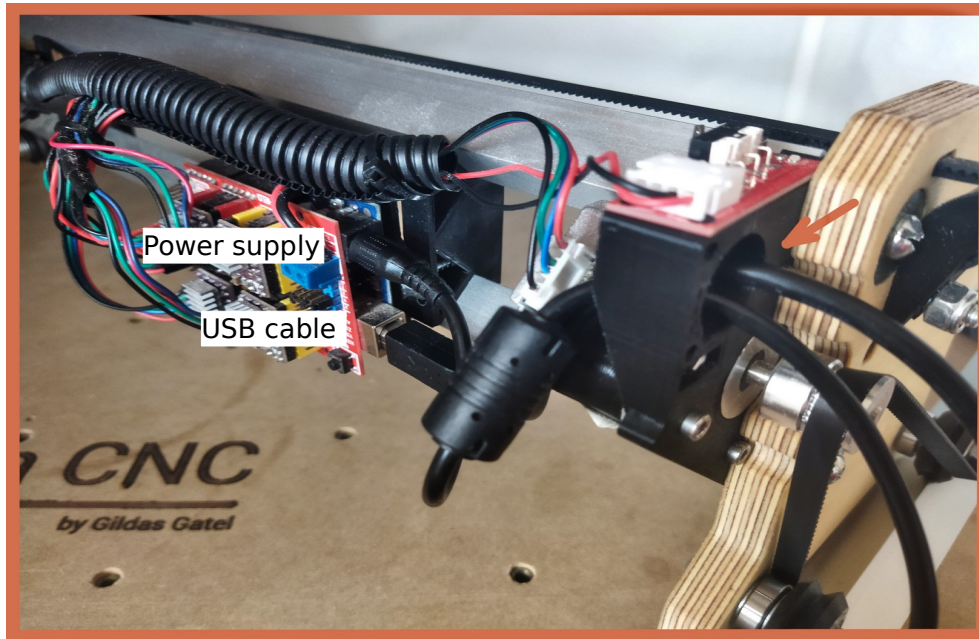

Connect the power supply and the usb cable to the motherboard passing through the ring.

Congratulations

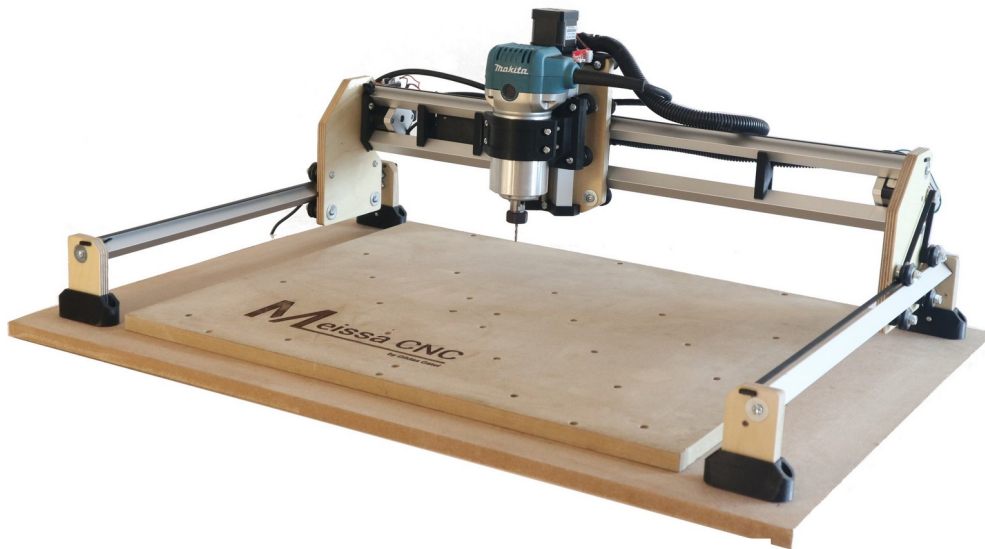

For more information see our website <https://meissacnc.com> or contact us at contact@meissacnc.com.